

Base Cabinet Assembly Instructions

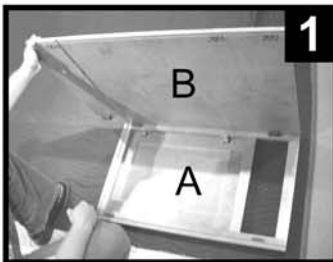

1
Lay front panel face-down on a non-marring surface. Push side panels (B) into slots on Front panel (A) making sure that cams connect properly.

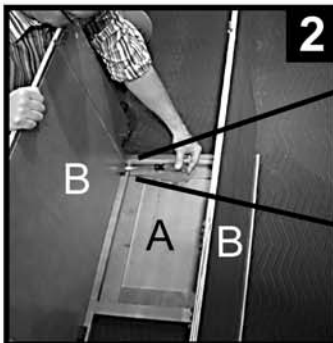

2
Tighten Cam locks with a flat-head screwdriver.

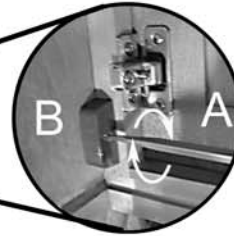

Cam lock detail.
(Turn until cam stops.)

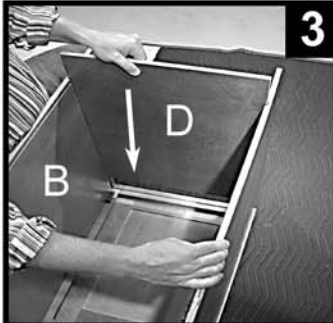

3
Slide base shelf (D) into grooves in sides (B).

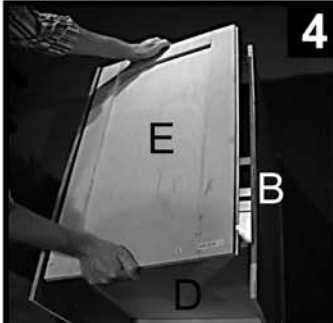

4
Insert back panel (E) into grooves in side panels (B).

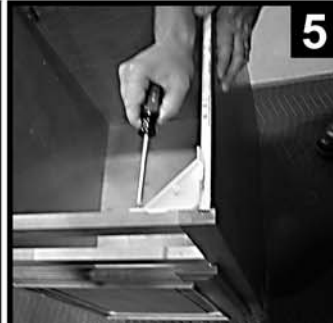

5
Install corner hardware using small screws.



6
insert rear drawer rail supports into holes and secure with small screws.



7
Insert drawer rails into rear supports & fasten with a small screw to front drawer frame.



Cabinet Base is ready for installation!

