

Drawer Assembly Instructions

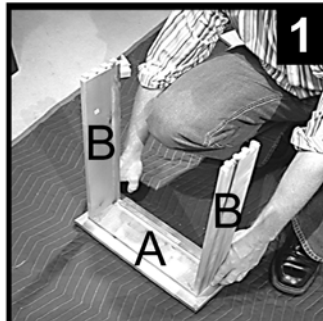

Lay drawer front face-down on a non-marring surface such as a towel or carpet. Align dovetails & slide drawer sides onto front. sides into dovetails

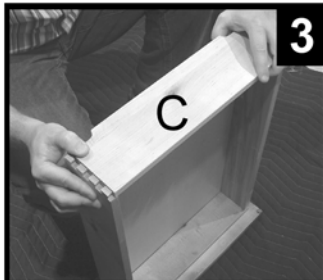

Align drawer rear and press dove tail joints together.

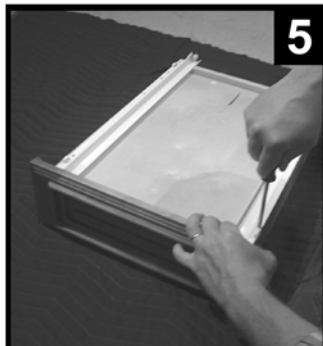

Attach drawer slide rails to drawer bottom with small screws.

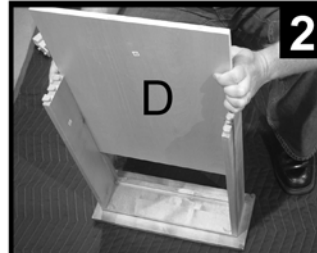

Slide drawer bottom into dadoes in drawer sides and front.

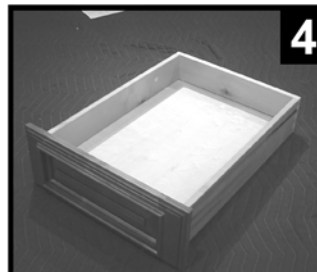

Picture of completed drawer.

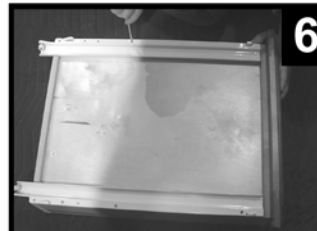
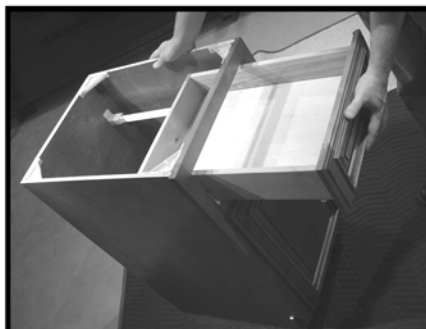

Photo showing completed rails.



Slide completed drawer into base unit.

NORBRIDGE
Quality Wood Cabinets